



F3786

T.E.T.[®] THESE = THOSE

#1 Glass Cleaner

PRODUCT DESCRIPTION:

A low VOC formula blends special ingredients to dissolve greasy film, fingerprints and smears. Leaves glass and reflective surfaces smudge and streak free. Effectively cleans glass, mirrors, Plexiglas[®], acrylic, stainless steel, chrome, countertops, tabletops and other reflective surfaces.

FEATURES:

User Friendly:

Glass Cleaner contains no "butyl" solvent, alcohol or ammonia. It has a neutral pH.

OSHA Compliance:

Each case provides secondary labels. The label provides directions for use in Spanish and English.

Environmentally Friendly:

Eliminates waste and reduces storage space.

Cost Effective:

The special blend of ingredients leaves glass and reflective surfaces clean and streak free. One 16 oz. bottle makes 16 ready-to-use quarts (1:32 ratio).

PRODUCT SPECIFICATIONS:

pH (concentrate)	6.8 ± 0.6
Appearance	Blue, Liquid
Fragrance	Camphor
Freezing Point	About 32°F
Solubility in Water	Complete
Flash Point	None

INGREDIENTS:

Water	7732-18-5
Dipropylene glycol n-butyl ether	29911-28-2
Sodium 1 Octane Sulfonate	5324-84-5

ECOLOGICAL INFORMATION

- Biodegradable Surfactants
- Neutral pH
- Contains no Phosphorus
- Low VOC

DILUTIONS	HEALTH	FLAMMABILITY	REACTIVITY
CONCENTRATE CONCENTRAR	HMPPA 1	HMIS 0	HMPPA 0
(1:32 RATIO) (1:32 RAZÓN)	HMPPA 0	HMIS 0	HMPPA 0
PROPORCIÓN	SALUD	INFLAMABILIDAD	REACTIVIDAD

0	1	2	3	4
Minimal	Slight	Moderate	Serious	Severe
Mínimo	Mínimo	Moderar	Grave	Drástico

T.E.T.® #1 Glass Cleaner CLEANS AND POLISHES GLASS AND OTHER REFLECTIVE SURFACES

DIRECTIONS

USE INFORMATION

*Always dilute in properly labeled quart bottles. Do not spray on electrical circuits. **Glass Cleaner** is safe for use on all washable hard surfaces. Use on glass, mirrors, Plexiglas®, acrylic, table tops, counter tops, vinyl, stainless steel, painted surfaces, baked enamel and other reflective hard surfaces.*

DIRECTIONS

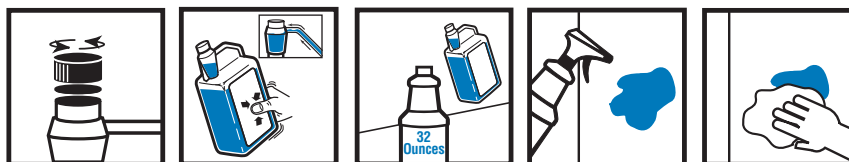

1. REMOVE CAP
2. SQUEEZE
3. POUR
4. SPRAY
5. WIPE

DIRECTIONS

1. **REMOVE CAP** and seal.
2. **SQUEEZE BOTTLE** and fill the portion control cup. Excess cleaner will automatically flow back into the bottle.
3. **POUR** the contents of the cup into an empty, properly labeled quart bottle. Fill the quart bottle with cool tap water and attach a sprayer (1:32 ratio).
4. **SPRAY** the surface to be cleaned.
5. **WIPE** with a clean, lint-free cloth or paper towel.

WARNING

Causes eye irritation. May cause skin irritation.

Prevention

Wash thoroughly after handling.

Response

If in eyes: Rinse cautiously with water for several minutes. Remove contact lenses, if present and easy to do. Continue rinsing. If eye irritation persists: Get medical advice / attention.

Storage

Store away from incompatible materials.

Disposal

Dispose of waste and residues in accordance with local authority requirements.

KEEP OUT OF REACH OF CHILDREN.

Franklin Cleaning Technology

One Fuller Way
Great Bend, KS 67530
United States
CHEMTREC (800) 424-9300
Emergency (620) 792-1711
24 hour Emergency (800) 424-9300
www.fullercommercial.com

PERSONAL PROTECTION:

Respiratory Protection: Not needed under normal conditions.

Ventilation: Use with adequate ventilation.

Eye Protection: Safety glasses are optional.

Protective Gloves: Protective gloves are optional.

Other Protective Clothing or

Equipment: Wear clothing as necessary to prevent skin contact.

TRANSPORTATION INFORMATION:

U.S. DOT - Proper Shipping

Name: Not regulated by DOT.

Marine Pollutant: No